

PX3 FAQ

Preliminary release 0.5

Q: What comes in the box with the PX3?

In the Box

In addition to the PX3 display itself, check the shipping box for the following contents.

Serial Data Cable

Connects the KXPA100 to a serial port on your personal computer to upload updated firmware and provide other functions. If needed a serial cable with an RS232 interface (order the KXSER). These cables are identical to and interchangeable with the serial interface cable used with the KX3 transceiver. If desired, you can make your own RS232 serial interface cable. See page 32 for the schematic diagram.



KXUSB



KXSER

PX3-KX3 Interface Cable (PX3CBL)

Connects the PX3 to your KX3 (See Figure 2 or Figure 3)

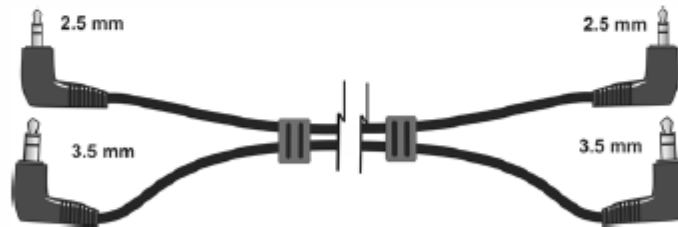

DC Power Cable (E850524)

Connects the PX3 your 9 to 16 Vdc power supply with tinned leads to connect to our power supply. Optionally you can purchase the PX3 DC Power Supply that plugs into a mains outlet as shown below. Order the (PWR121A-US).



Q: I already have a KX3, what do I need to order with my PX3 to obtain a fully integrated PX3/KX3 combination?

Q: I already have a KX3/KXPA100 combination. What do I need to order with my PX3 to obtain a fully integrated combination?

A: With either setup, [you can order the PX3 as shown here on our PX3 Order Page](#).

Follow these steps:

- 1) Select either the PX3-K, kit version or the PX3-F, factory-built version.
 - a. Connecting cables to the KX3 are shipped with the PX3 and will be in the box with it when it arrives to you. There is nothing else needed for connecting it to your KX3.
- 2) Order the PWR12V1A-US for use in your shack or anywhere you have 120V AC for power.

*** NOTE: The PWR12V1A-US can power the only the PX3. It is *not* intended to power the KX3. ***

NEW PX3 Panadapter for KX3 NEW



<input type="checkbox"/> PX3-K	Panadapter for KX3	499.95
<input type="checkbox"/> PX3-F	Panadapter for KX3	579.95
<input type="checkbox"/> PWR12V1A-US	Power Supply for K3/0-Mini, 12 V, 1A, 100-240 V, (US Plug Only) (The PX3 comes with a pigtail power cable standard. If desired, purchase the optional Power Supply module.)	19.95



[PX3 Datasheet](#) [Check Shipping Status](#)

[Add to Cart](#)  (Click on this button to add checked items in this section to your shopping cart.)

Q: I am planning on installing my PX3/KX3 combination in a Go-Box. What are the dimensions of the PX3?

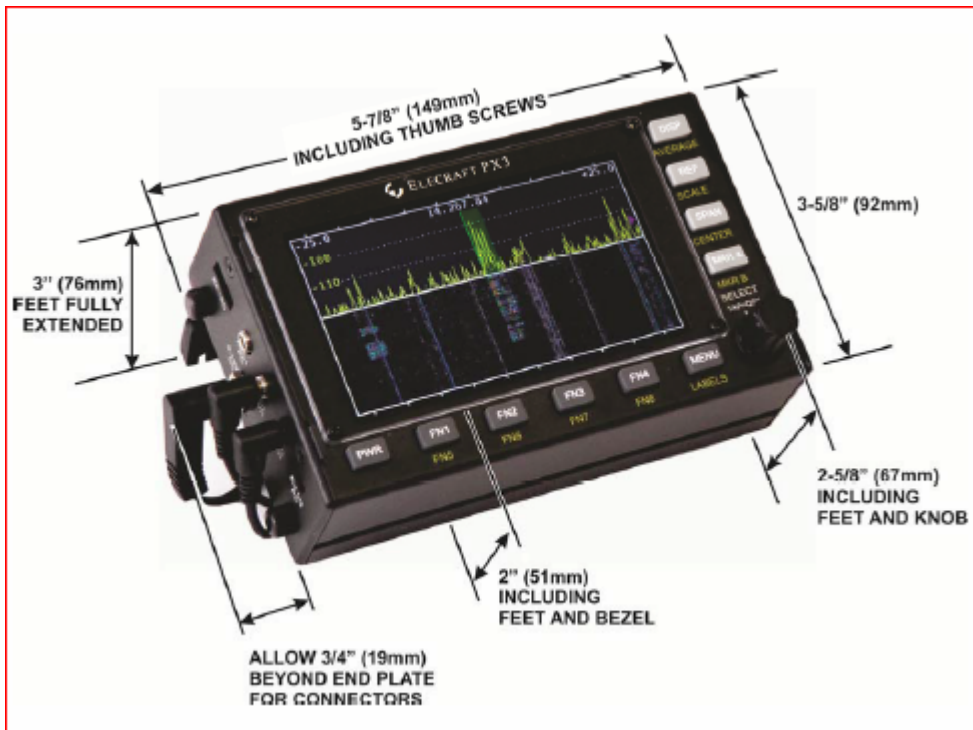

A:

Connecting the PX3 to the KX3/KXPA100

Q: What are the supported methods for connecting the PX3 to my KX3 and KX3/KXPA100 combo?

All Elecraft PX3 cabling is designed to support the following wiring methods.

For the PX3 and KX3, here are the interconnections.

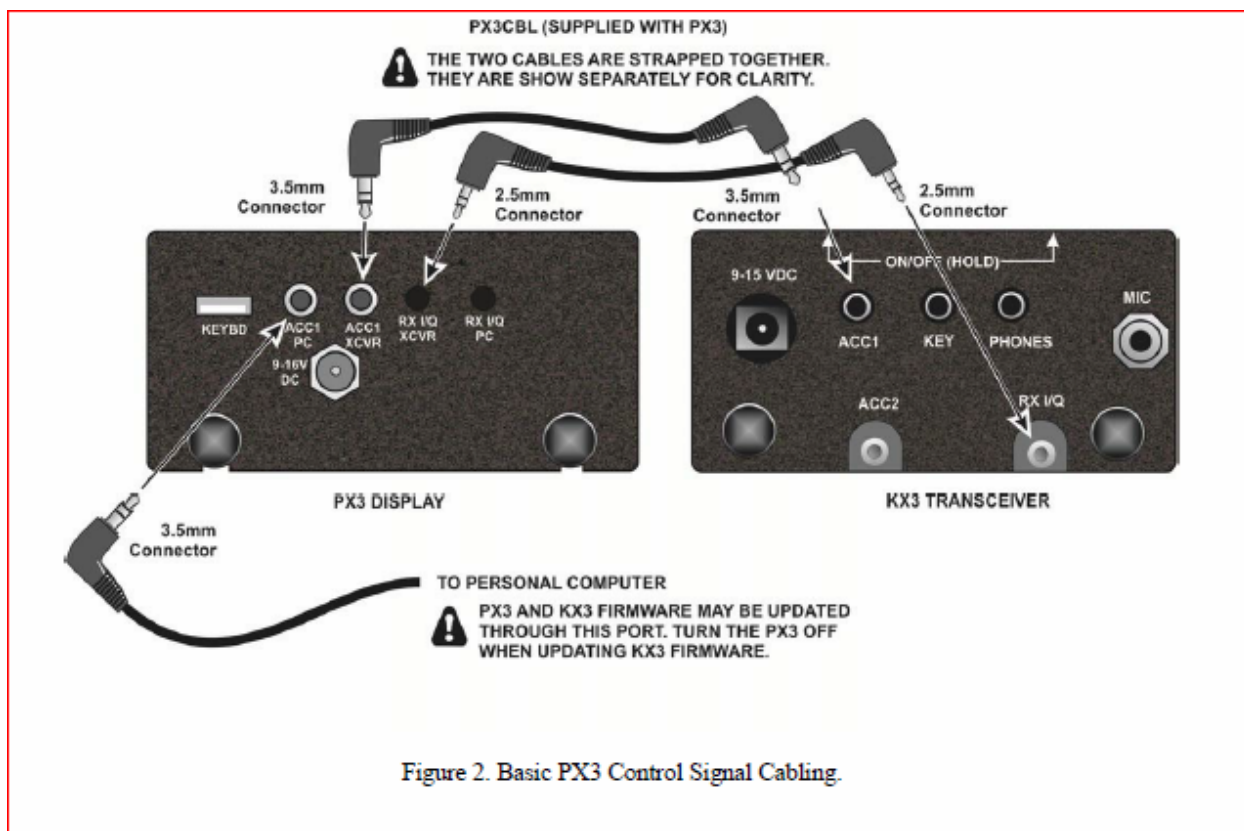

When used with the KX3 and KXPA100 combo, the wiring will be arranged in this way.

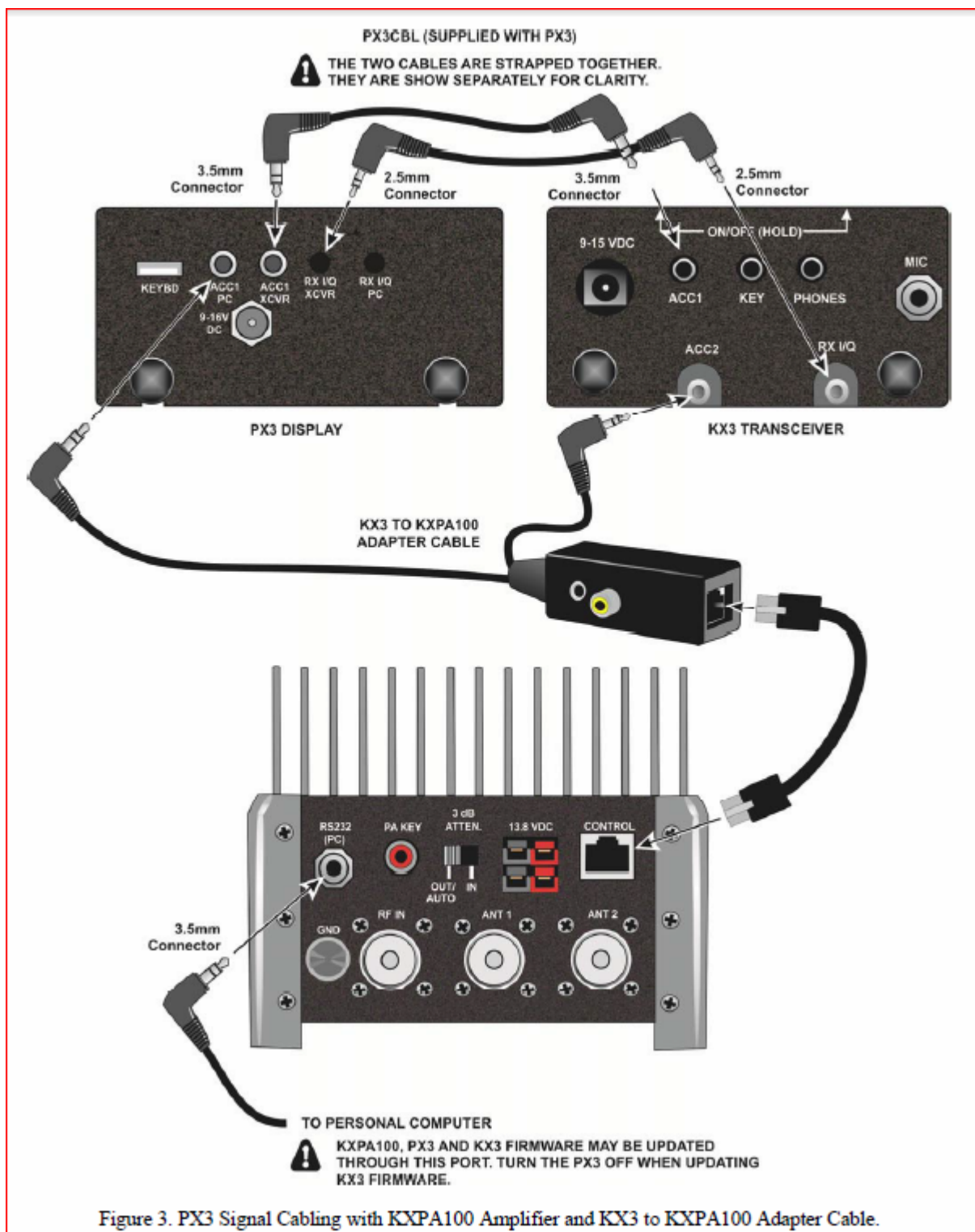

Figure 3. PX3 Signal Cabling with KXPA100 Amplifier and KX3 to KXPA100 Adapter Cable.

Powering the PX3

Q: I see there is a separate power connector for the PX3. How to I power the KX3 and PX3 for portable use?

A: The PX3 is shipped with its own power cable as does the KX3. While the KX3 cannot power the PX3 from its own batteries, both the KX3 and PX3 can be powered from an external source. Connect the 2 power cables together for this purpose. In this way, you can monitor battery voltage directly from the KX3.

Q: I am planning to take my PX3 and KX3 portable, what are the PX3 power requirements?

A: The PX3 has a wide supply voltage range (8-15 V) and low current drain (typ. 140 mA @ 13.8 V).

Q: I see there is an AC power supply available for ordering on the PX3 web site. What is the PWR12V1A power source's intended use?

A: This is intended to directly power the PX3 when 120v is available. It will ship with an adapter cable for the right angle connection to the PX3.

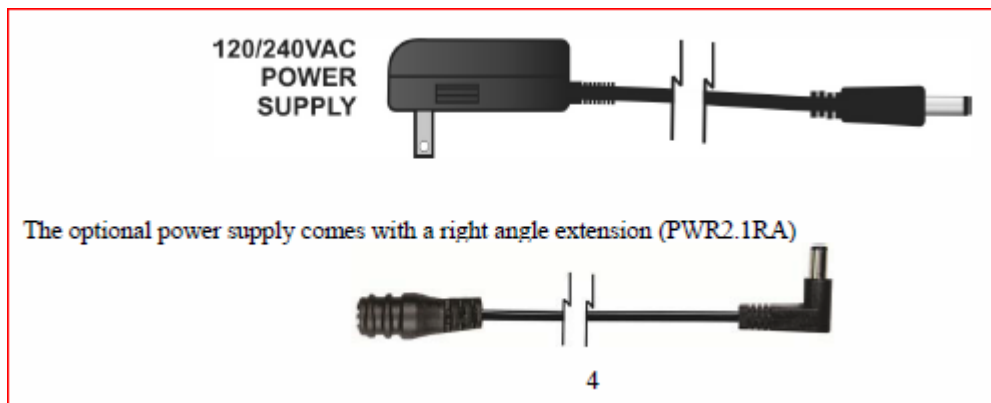

Q: Will the PWR12V1A also power the KX3?

A: No. This power supply is intended only for the PX3. It does not supply sufficient current to run a KX3 at rated output.

Operating the PX3 with other radios

Q: How can I use the PX3 with other radios?

A: Yes, you can if your radio has I/Q signals available, you can connect the PX3 to it to see RF spectrum with it. Due to the highly integrated nature of the KX3/PX3 combination, there will be some features of

the PX3 not available when connected in this way. You will, however, be able to see RF spectrum activity with the PX3.

Q: Does the PX3 work with the K3?

A: No. The PX3 requires I/Q signals for input which is supplied by the KX3. The PX3's companion product, the P3, uses Intermediate Frequencies for input, which is supplied by the K3. Both units are optimized for operation with their respective radios. The result is full integration for both. They cannot, however, be interchanged for this reason.

Q: Can I use the P3 with a KX3?

A: No, the KX3 is a direct-conversion receiver which means that it does not have an Intermediate Frequency. Since the P3 requires an Intermediate Frequency for operation, it will not work with the KX3.

Using the PX3 with logging and CAT control programs

Q: My logging program requires that it be able to connect to the KX3. How does this work when the PX3 is connected to the KX3's ACC1 port?

A: The PX3 has been engineered to be 'transparent' to any computer program that needs to gain access to the KX3's frequency and mode information. That is, your logging program will be able to access the KX3 even though you have a PX3 connected with it. You will be connecting your computer's cable to the PX3's ACC1 port, which provides this 'pass-through' feature.

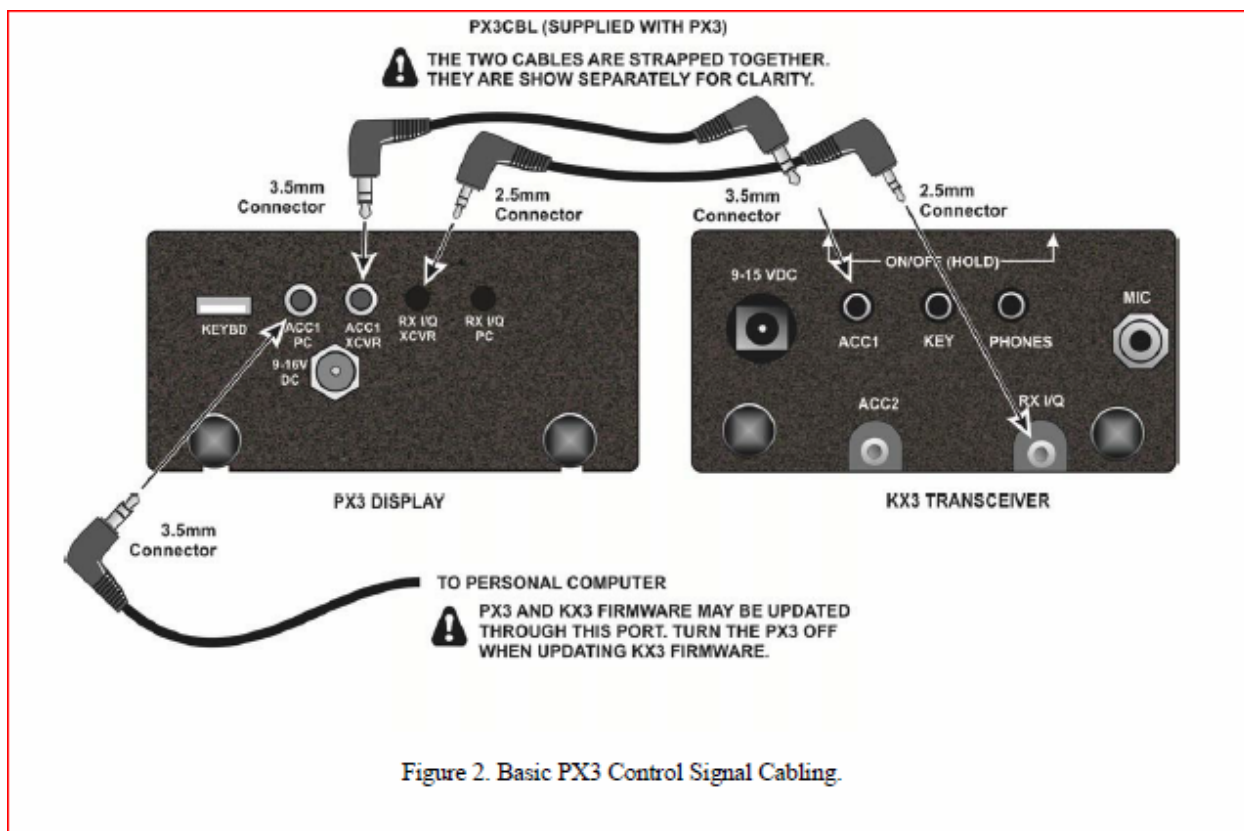

Figure 2. Basic PX3 Control Signal Cabling.

**** End of FAQ ****